

# GHM1

## FLANGE / FLANGES

## ALBERI / SHAFTS

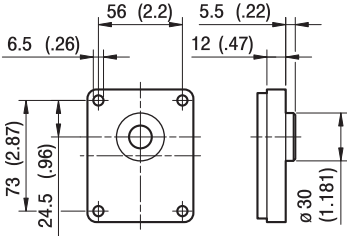

**TO**

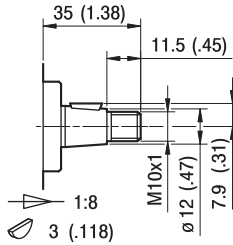

**TO**

Coppia Max  
Max Torque 90 Nm

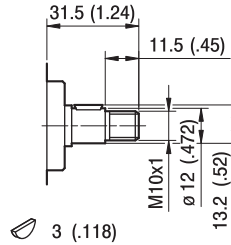

**CO**

Coppia Max  
Max Torque 25 Nm

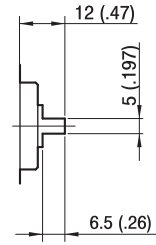

**GO**

Coppia Max  
Max Torque 35 Nm

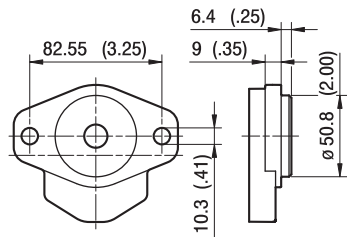

**A**

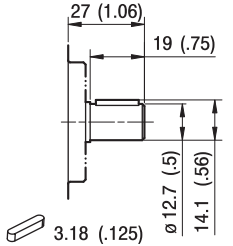

**C1**

Coppia Max  
Max Torque 55 Nm

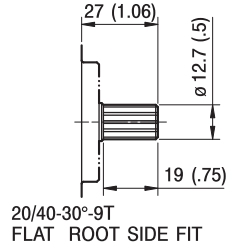

**S1**

Coppia Max  
Max Torque 55 Nm

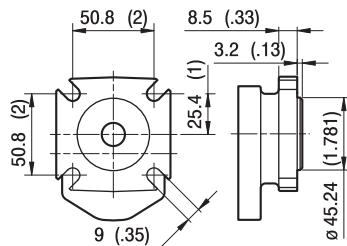

**AQ**

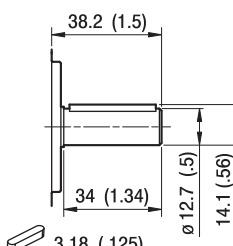

**C2**

Coppia Max  
Max Torque 95 Nm

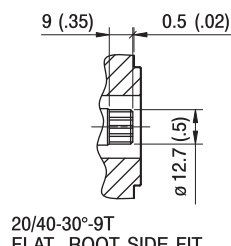

**S2**

Coppia Max  
Max Torque 55 Nm

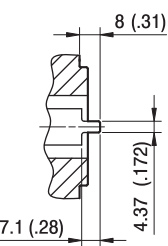

**G1**

Coppia Max  
Max Torque 25 Nm

# GHM1

## PORTE / PORTS

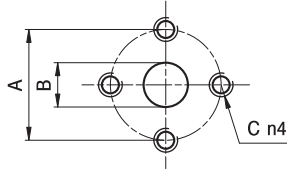

### E

TIPO TYPE	MOTORE BIDIREZIONALE BI-DIRECTIONAL MOTOR			MOTORE MONODIREZIONALE MONO-DIRECTIONAL MOTOR		
	USCITA - ENTRATA OUTPUT - INPUT			ENTRATA INPUT		
	A	B	C	A	B	C
GHM1...4 ÷ GHM1...16	30	13	M6	30	13	M6

I valori delle coppie di serraggio delle viti presenti nel kit raccordo sono indicate a pag 52 (capitolo accessori).  
Tightening torques of the fittings screws are specified on page 52 (accessories section).

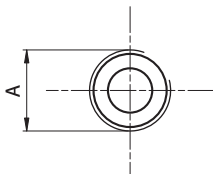

### FG

TIPO TYPE	MOTORE BIDIREZIONALE BI-DIRECTIONAL MOTOR			MOTORE MONODIREZIONALE MONO-DIRECTIONAL MOTOR		
	USCITA - ENTRATA OUTPUT - INPUT			ENTRATA INPUT		
	A			A		
GHM1...4 ÷ GHM1...5	G1/2			G3/8		
GHM1...6 ÷ GHM1...16	G1/2			G1/2		

Raccordo G1/2 coppia di serraggio massima 50 Nm. Raccordo G3/8 coppia di serraggio massima 35 Nm.  
Consigliamo di richiedere conferma al fornitore del raccordo.  
Tightening torques for G1/2 fitting: 50 Nm. Tightening torques for G3/8 fitting: 35 Nm. Please check with the fittings suppliers.

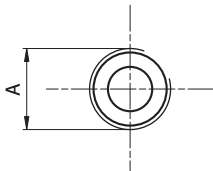

### FC

TIPO TYPE	MOTORE BIDIREZIONALE BI-DIRECTIONAL MOTOR			MOTORE MONODIREZIONALE MONO-DIRECTIONAL MOTOR		
	USCITA - ENTRATA OUTPUT - INPUT			ENTRATA INPUT		
	A			A		
GHM1...4 ÷ GHM1...16	Rc1/2			Rc1/2		

Raccordo Rc1/2 coppia di serraggio massima 50 Nm.  
Consigliamo di richiedere conferma al fornitore del raccordo.  
Tightening torques for Rc1/2 fitting: 50 Nm. Please check with the fittings suppliers.

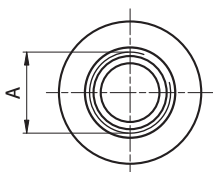

STANDARD SAE J1926/1

### FA

TIPO TYPE	MOTORE BIDIREZIONALE BI-DIRECTIONAL MOTOR			MOTORE MONODIREZIONALE MONO-DIRECTIONAL MOTOR		
	USCITA - ENTRATA OUTPUT - INPUT			ENTRATA INPUT		
	A			A		
GHM1...4 ÷ GHM1...9	3/4-16 UNF			9/16-18 UNF		
GHM1...11 ÷ GHM1...16	7/8-14 UNF			3/4-16 UNF		

Raccordo 9/16-18 UNF coppia di serraggio massima 30 Nm. Raccordo 3/4-16 UNF coppia di serraggio massima 60 Nm.  
Raccordo 7/8-14 UNF coppia di serraggio massima 70 Nm. Consigliamo di richiedere conferma al fornitore del raccordo.  
Tightening torques for 9/16-18 UNF fitting: 30 Nm. Tightening torques for 3/4-16 UNF fitting: 60 Nm.  
Tightening torques for 7/8-14 UNF fitting: 70 Nm. Please check with the fittings suppliers.



Nel caso di funzionamento a pressioni elevate e intermittenti è possibile una riduzione della resistenza a fatica del corpo.  
A reduction of body's fatigue strength may occur if the pump is working at elevated and intermittent pressures.