

# GHP35

Parti accessorie a corredo della pompa standard: linguetta a disco (codice 522060), dado M16x1.5 (codice 523018), rosetta elastica spaccata (codice 523007).  
 Porte standard: filetti M10 profondità utile 19 mm.

Accessories supplied with the standard pump: woodruff key (code 522060), M16x1.5 hexagonal nut (code 523018), washer (code 523007).  
 Standard ports: M10 threads depth 19 mm.

MANDATA  
 OUTLET

ASPIRAZIONE  
 INLET

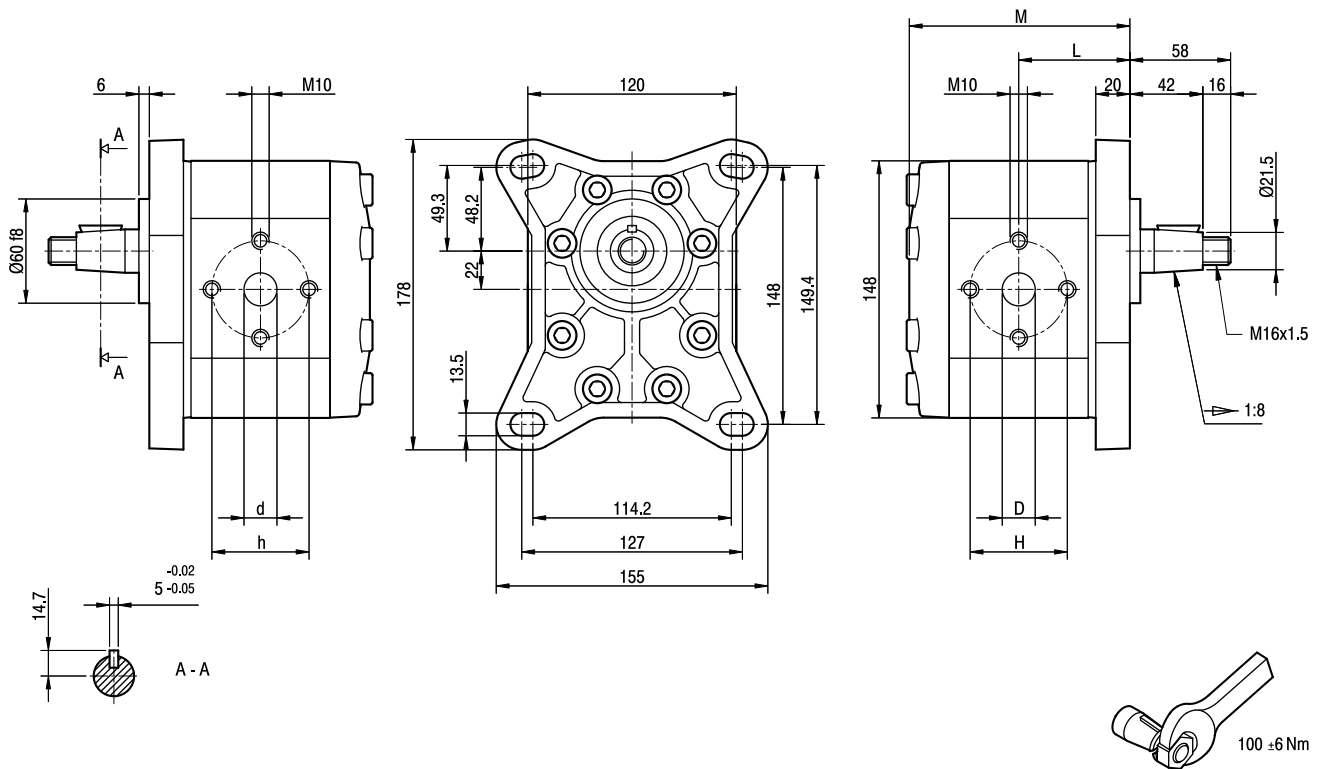

TIPO TYPE	CILINDRATA DISPLACEMENT		PRESSIONI MASSIME MAX PRESSURE			VELOCITÀ MASSIMA MAX SPEED	DIMENSIONI DIMENSIONS					
	cm <sup>3</sup> /giro [cm <sup>3</sup> /rev]	litri/min [litres/min]	P <sub>1</sub> bar	P <sub>2</sub> bar	P <sub>3</sub> bar		L mm	M mm	D mm	d mm	H mm	h mm
GHP35-D-66	44	62	250	265	280	2800	72	143	27	27	51	51
GHP35-D-80	52	74	230	245	260	2400	75	149	27	27	56	56
GHP35-D-94	61	87	210	225	240	2800	78	155	33	27	62	51
GHP35-D-110	71	101	200	215	230	2500	81,5	162	33	27	62	51
GHP35-D-120	78	112	180	195	210	2300	84	167	33	27	62	51
GHP35-D-135	87	124	160	175	190	2000	87	173	33	27	62	51